

**Go Traffic Management**

The following has been prepared as a guide only. It is not intended to be used as a legal document. It is the responsibility of the user to ensure that the information is correct and that it is used in accordance with the relevant legislation. The user must ensure that the information is used in accordance with the relevant legislation. The user must ensure that the information is used in accordance with the relevant legislation.

- 1. All signs are per Chapter 8, Divisions between cones to be 5m
- 2. Distances between signs NOT to exceed for purpose of clarity
- 3. All sign placement subject to conditions site working space
- 4. The purpose of this Traffic Management Plan is to ensure that the road is used safely and efficiently. It is not intended to be used as a legal document. It is the responsibility of the user to ensure that the information is correct and that it is used in accordance with the relevant legislation. The user must ensure that the information is used in accordance with the relevant legislation.
- 5. Lane width past the cones to be 3.5m minimum, 3.25m desirable
- 6. minimum 2m 2.5m outside minimum
- 7. Signs must be placed in accordance with 150m and the scheme
- 8. permanent signpost failure in accordance with code of practice
- 9. Signs must be placed in accordance with 150m and the scheme
- 10. Signs must be placed in accordance with 150m and the scheme

**NOTES**

	Signification
	Work zone
	Diversion Route 1
	Diversion Route 2

**WRITTEN DIVERSION ROUTE:**  
Dry Mill Lane <-> The Lakes Road <-> Yew Tree Lane <-> Cleobury Road <->

**MINIMUM SAFETY ZONE**  
MINIMUM SAFETY ZONE WIDTHS MUST BE ADHERED TO  
TRAFFIC MANAGEMENT MUST COMPLY WITH THE SAFETY OF STATIONARY AND ROAD WORKS CODE OF PRACTICE

**ROAD SPEED**

**CROSS SECTION**  
Lane 1 Closure of Shuttle Lane

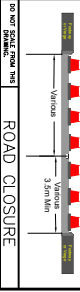

**ROAD CLOSURE**

NO. OF ROAD CLOSURE SIGNS	ROAD CLOSURE
A	06/06/22
REV.	DATE
AS DRAWN	DESCRIPTION

**GTM**  
Go Traffic Management

Head Office: Go Traffic Management, 11M  
Oxford Road, Worsley, Manchester, M28 1XW  
Tel: 0161 251 5370  
www.gtm.co.uk

**TRAFFIC MANAGEMENT PLAN**  
SEVERN  
TRENT  
WATER

Name	Design	Technical Officer	REV
L. Cochrane			A
Issue Date	06/06/22	06/06/22	